

FORM NO. 1.

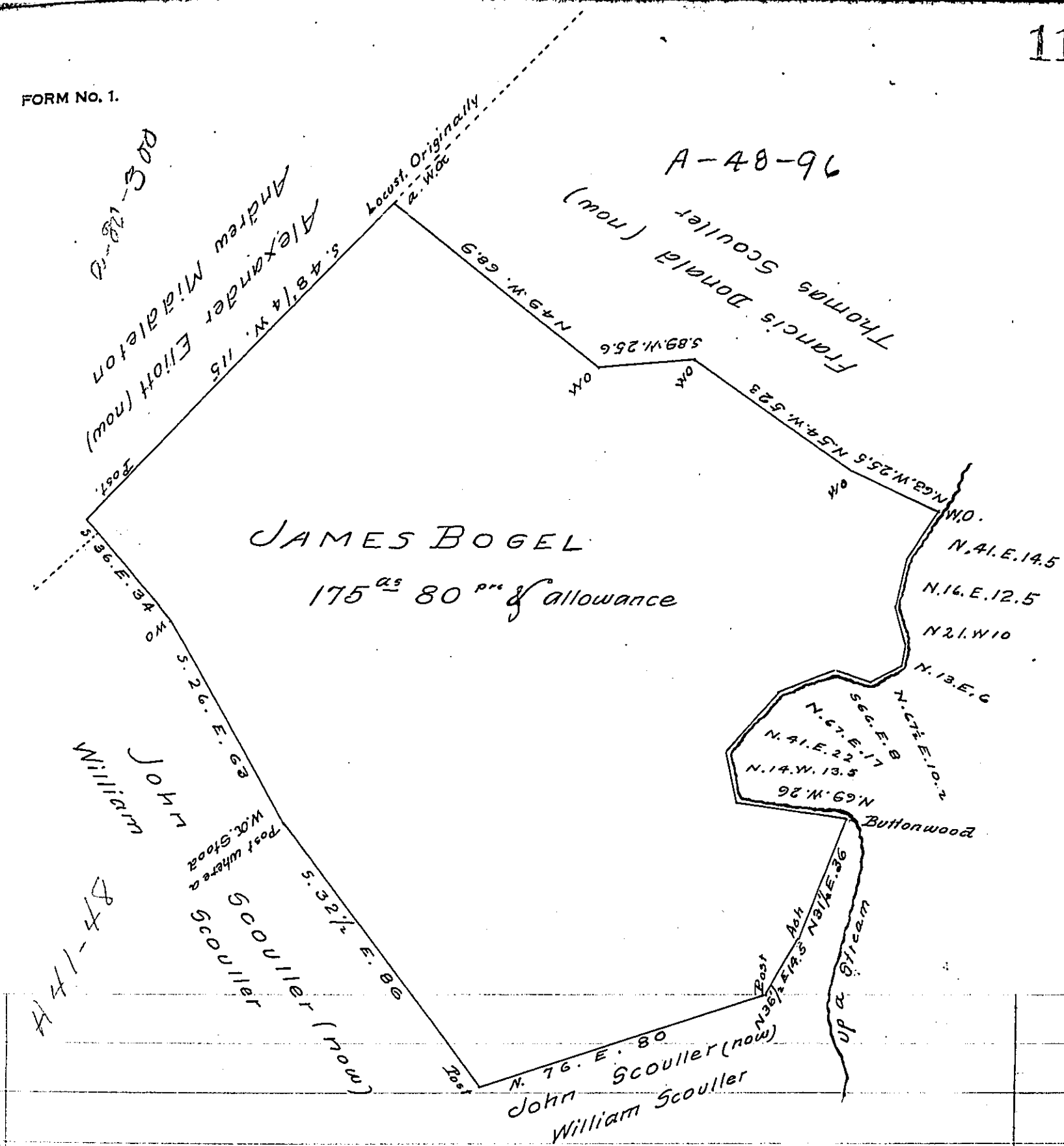

A Draught of a Tract of land situate in Mifflin Township Cumberland County containing One hundred & seventy five acres & Eighty perches and the allowance of six per Cent &c. surveyed 9<sup>th</sup> of April 1841 in pursuance of a Warrant granted to James Bogel for 200 acres including an improvement - bearing date 13<sup>th</sup> April 1787 -

The above surveyed for Philip Ramp

Patrick Davidson D.S.

To Jacob Sallade Esq  
Surveyor General

IN TESTIMONY that the above is a copy of the original remaining on file in the Department of Internal Affairs of Pennsylvania, made conformably to an Act of Assembly approved the 16th day of February 1833, I have hereunto set my hand and caused the Seal of said Department to be affixed at Harrisburg, this eleventh day of September 1907

*Henry Howard*  
Secretary of Internal Affairs.